

Howard Place

Brighton





We know just the place...



Guide Price £600,000-£650,000

Perfectly placed for all the cafes, shops and delis of Seven Dials and within a short stroll from highly regarded schools and the mainline station, this superb three storey home has a wealth of versatile space. Sitting at the end of a terrace of classic period houses, a stylish interior blends wood floors and bay windows with refined heritage tones and contemporary finishing touches. Light filled and fluid, its generous proportions include an open plan garden level floor with kitchen and dining room, an excellent reception room and fantastic family bathroom. Three double bedrooms have plenty of options for a study/home office, while outside a south facing walled garden is landscaped and tiered.



3



1



1



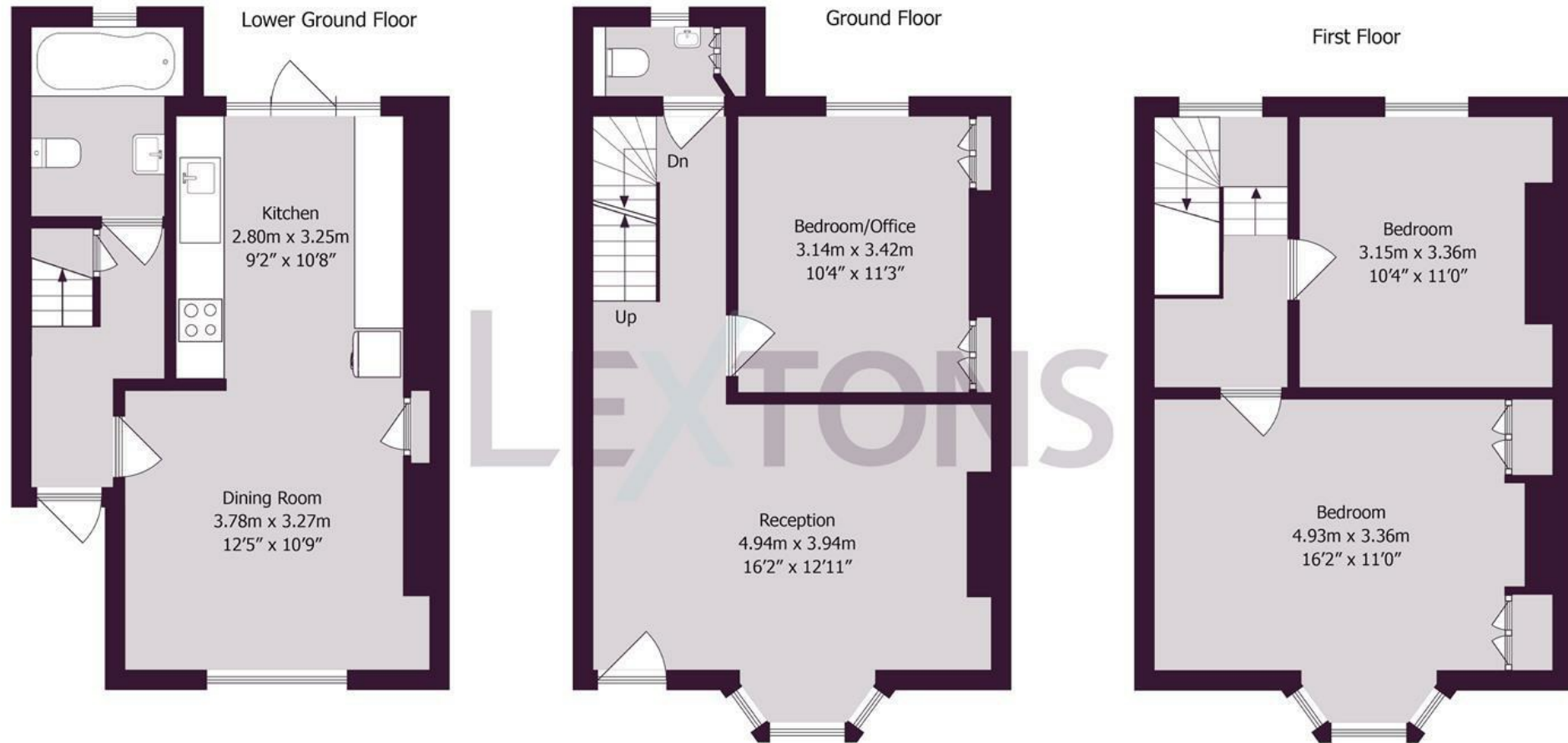

Approximate gross internal floor area 105.5 sq m/ 1136 sq ft

Whilst every care has been taken to ensure accuracy, dimensions are approximate and for illustrative purposes only.

Created by Property Photography UK for Lextons. All rights reserved.

Meet us here...
35 South Road
Brighton
BN1 6SB

We aim to make our particulars both accurate and reliable. However they are not guaranteed; nor do they form part of an offer or contract. If you require clarification on any points then please contact us, especially if you're traveling some distance to view. Please note that appliances and heating systems have not been tested and therefore no warranties can be given as to their good working order.



LEXTONS.co.uk